

Alkaline Water Ionizer

User Manual

(ALPHA-U1500/ U1700)



Table of Contents

1. Electricity Safety Information	01
2. Installation Precautions	03
3. Precautions While Using	05
4-1. Part Name - Main Body	09
4-2. Part Name - Faucet I	10
4-3. Part Name - Display	11
4-4. Part Name - Faucet II	12
5. Instructions For Use	13
6. Component Parts - Faucet	15
7. Installation	17
8. Basic Functions	21
9. How to Release Alkaline Water	22
10. How to Release Purified Water	23
11. How to Release Acidic Water	24
12. How to Set Button Lock	25
13. Water Flow Rate Per Minute	26

14. Setting Mode 01 Breakdown	28
15. Setting Mode 02 Breakdown (Checking Mode)	33
16. Measuring pH/ Replacing Fuse	39
17. Filter Configuration	40
18. Replacing Filter	41
19. How to Reset Filter	42
20. Troubleshooting	43
21. Specifications	44
22. Product Warranty	45

I. Electricity Safety Information

- ▶ Please follow the instructions below to prevent any unexpected risk or damage.
- ▶ Safety-related information is divided according to the urgency of the risk and the expected loss.



Danger

If the instructions are not followed, death or serious disability is expected



Warning

If the instructions are not followed, significant physical or material harm is expected



Caution

If the instructions are not followed, minor physical or material harm is expected

- ▶ This symbol represents the operations that may be dangerous and in need of attention.
- ▶ When this symbol is present, instructions must be followed carefully in order to avoid any risk.



Cause of electric shock and fire

Always clean the power plug before using it by wiping off any remains or dust on it. If either the power cable or the power plug is damaged or if the outlet is loose and can be shaken easily, stop using it and call the maintenance service. Electric shock or short circuit could cause fire.

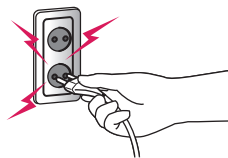

Do not bend electric cord

Do not damage, modify, bend, pull, or twist the electric cord. It may cause an electric shock, short circuit, or fire.

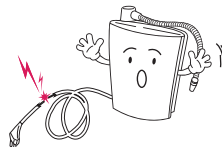



Cause of electrocution

Do not pull or insert power plug with wet hands. It may cause electrocution

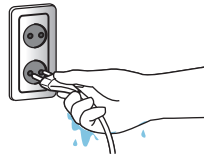

Use of correct outlet

Please only use an outlet that is rated higher than 10A. Octopus wiring may cause fire due to overheating

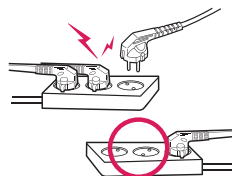

When repairing product

Unplug power plug when repairing or inspecting product or when exchanging parts. Failure to do so may cause electrocution.

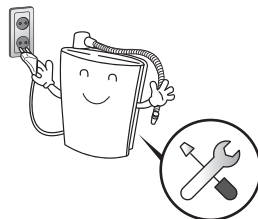

Do not use warm water!

Do not connect device directly with warm water (warmer than 30°C). It may cause malfunction or accident. Do not use water with high hardness. Do not use water that is not suitable for drinking.



2. Installation Precautions



WARNING

Tap water as source water

It is recommended to use tap water as source water. Do not use underground water, polluted water, and water with high hardness as source water. Do not use warm water as source water. Do not use water unsuitable for drinking (Unsuitable source water based on Waterworks Law).



WARNING

Prohibition of arbitrary disassembly or renovation

Do not use the power cord after arbitrarily disassembling or renovating it. Do not arbitrarily disassemble or renovate the product. It could become the cause of electric shock or fire.

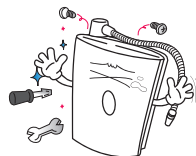

WARNING

Install the product away from the wall

Install the product at least 20cm away from the wall. It could become the cause of malfunction.

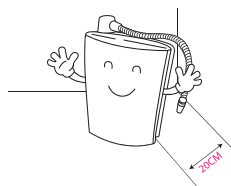

DANGER

Avoid installing on sloped and shaky areas

Do not apply excess strength or force on the product. Please, install main unit on a level surface. Do not install product in a sloped or shaky area. Dropping the product or collision may cause damage.

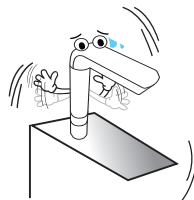



Cause of electrocution and short circuit

Do not use in humid places such as bathroom. Do not spray water on product or clean product with water. It may cause electrocution and short circuit.

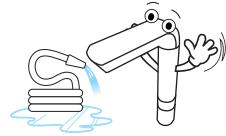

Do not fold the hose

Make sure the water hose doesn't get tangled or folded, it could become the cause of leakage or short circuit.

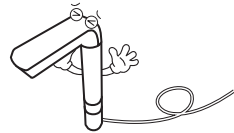

Avoid heated area

Do not install near heating equipment or place candle or lighted cigarette on top of product. Do not install on place in direct contact with fire, exposed to direct sunlight, or near heating equipment such as stove or electric heater. It may cause malfunction or fire.

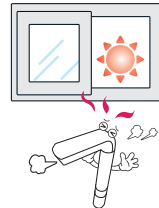

Place this product near a sink and always allow the water to drain into the sink.

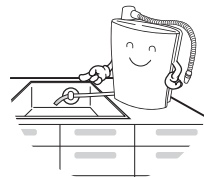

If the unit is not used for a few days, let the water run for 3 ~ 5 minutes before drinking functional water.

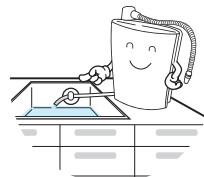

3. Precautions while using



CAUTION

Elderly, people with physical or psychological disabilities, or those who lack experience and knowledge should not be using this product.

Children need to be supervised to prevent them from using the product as a toy.



CAUTION

In case of water shortage

Please unplug the power cord in case of water shortage. It could become the cause of product malfunction.



DANGER

Prohibition of any impact to the product

Do not exert any excessive shock to the product. It could become the cause of electric shock or product malfunction.

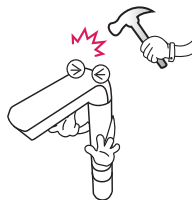

DANGER

Do not move the product while operating

Please do not move the product while it is still operating. Do not tilt the product over 45 degrees while moving the product. It could become the cause of product malfunction.





If the unit won't be used for a long time, shut off the valve and unplug the power cord.

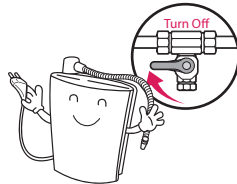

If you hear strange noises, smell a burning odor or see smoke, unplug the power cord immediately and call qualified personnel for service.

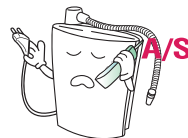

Do not place any objects on top of this unit no matter how small they are.



If water leaks out of the unit (other than the hoses) or if the unit is standing in a puddle of water, shut off the water supply, unplug the power cord and contact qualified service personnel for service.

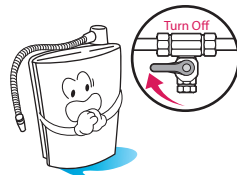

Do not poke or scratch the touch pad or LED display with sharp objects.





In areas of hard water (calcium scaling present on faucets), notify your service provider and install a cell safe anti-scale prefilter to protect the ionizer from scaling.



Supply water for goldfish, tropical fish, etc.

Do not use alkaline water or acid water as supply water for fish tank with goldfish, tropical fish, etc.



Do not insert any sharp objects

Do not insert any sharp wires or drivers into the product. It could become the cause of electric shock or product malfunction.

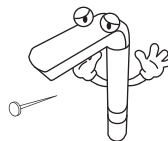

When cleaning (electrocution, fire)

When cleaning, do not use benzene, thinner, cleanser, or pesticide. Do not place bowl with water, drug, food, or small metal on top of the product. If it enters inside the product, it may cause electrocution, fire, or malfunction.





- ▶ **When disposing appliances or water filters, please follow the specified procedure.**
 - It becomes the cause of environment pollution.
- ▶ **When installing parts, please use the parts provided from our own company. (Water valves, water hoses, water filters etc.)**
 - Otherwise, it could cause leakage or product malfunction.
- ▶ **When replacing the water filter, please only use the filter from our own company.**
 - It could become the cause of abnormality of water quality or taste.
- ▶ **Do not install the product in locations where there is a risk of freezing in winter.**
- ▶ **The appliance is not to be used by persons (including children) with reduced physical, sensory or mental capabilities, or lack of experience and knowledge, unless they have been given supervision or instruction.**
- ▶ **Children should be supervised not to play with the appliance.**

4-1. Part Name - Main Body

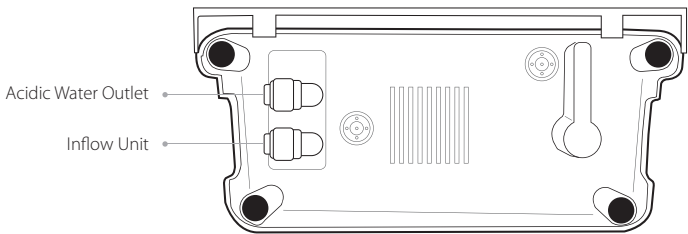
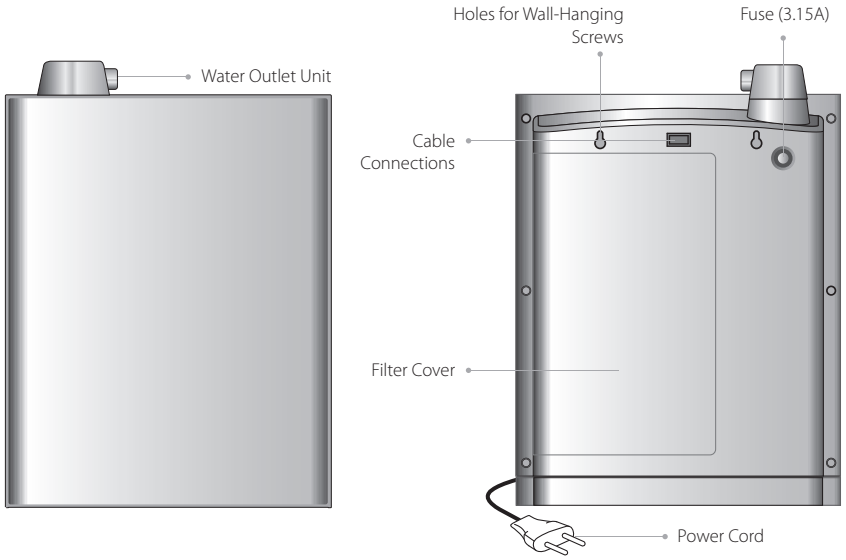

4-2.Part Name - Faucet I

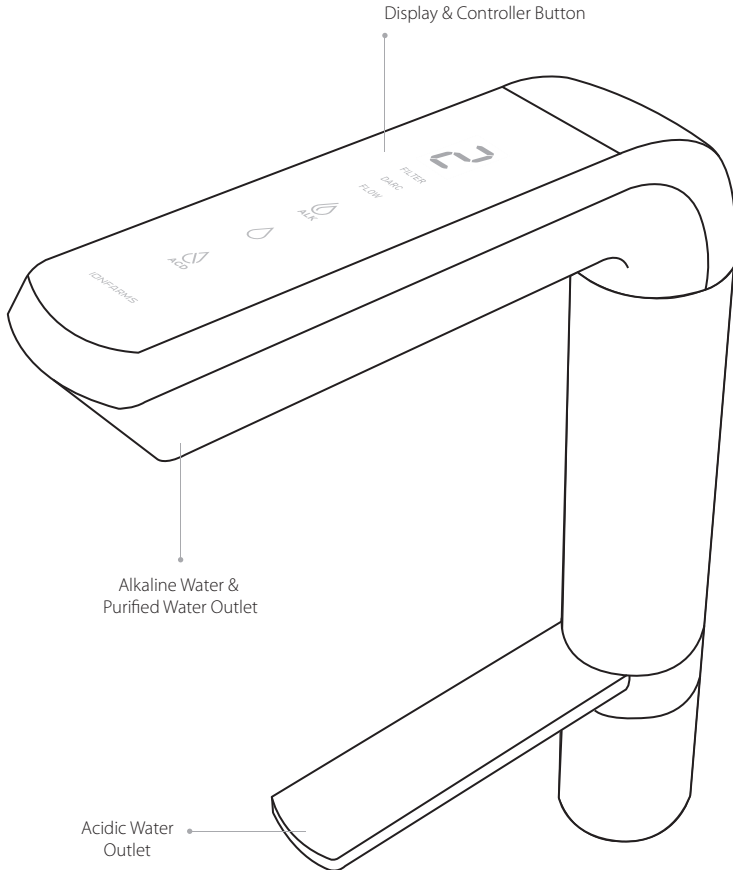

4-3.Part Name - Display

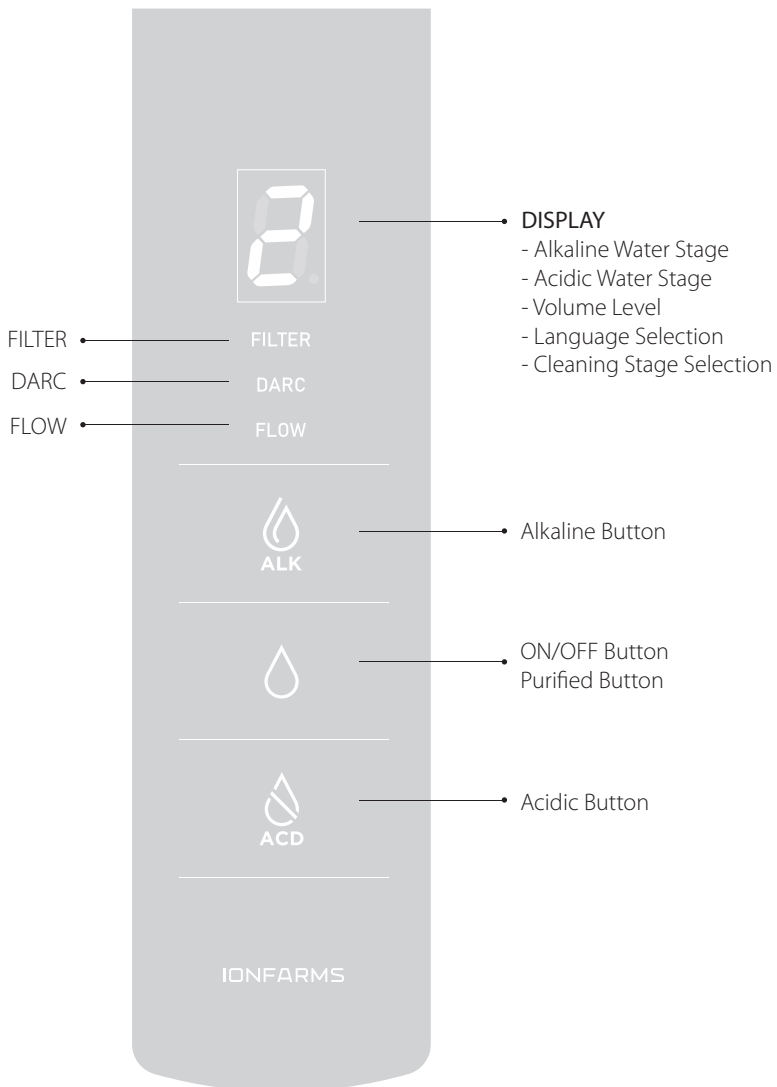

4-4.Part Name - Faucet II

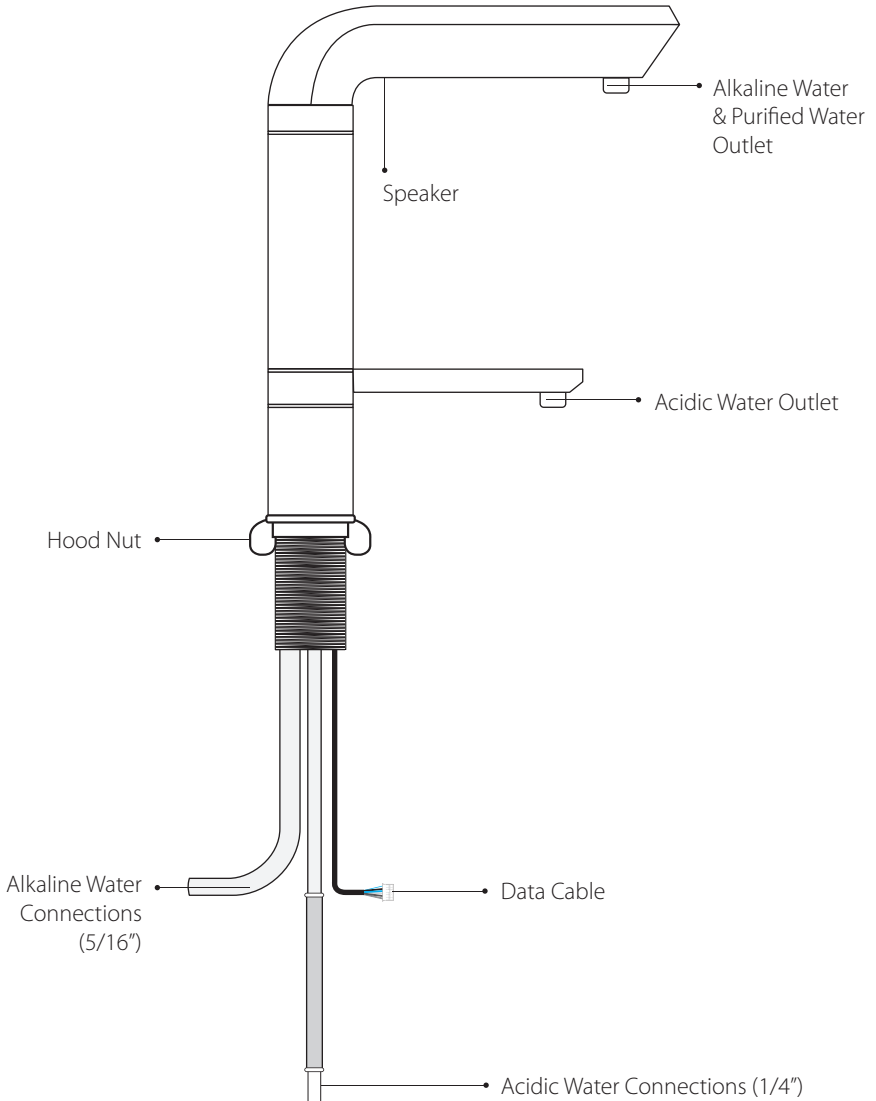

5. Instructions for Use

Before Use

- ▶ Choose a safe place for installation.
- ▶ Connect with tap water.
- ▶ Flush generated water for 3-5 minutes after installation is completed.
- ▶ Prepare a plastic cup or glass container for collecting drinking water. Do not use a metallic container.
- ▶ Do not drink functional water with medication. When taking medication, use “clean H₂O” filtered water thirty minutes prior to taking medication as well as with medication. You may resume drinking functional water thirty minutes after taking medication.
- ▶ Always consult your primary care physician before drinking functional water. Only drink a small amount near a neutral pH level for the first week. This will give the body time to adjust to functional water during the detoxification period. See Welcome Guide for full details on getting started.
- ▶ If you notice any negative effects from drinking functional water, stop drinking the functional water immediately and consult your primary care physician about changes in your body’s pH level.
- ▶ If you are currently under the care of a primary care physician for an existing condition, consult your primary care physician about how changes in pH and other characteristics of functional water could affect your medical condition.
- ▶ If you suffer from gastric acidity, kidney failure or potassium excretion, you should not drink functional water.
- ▶ Verify the pH levels of the functional water dispensed from this unit on a monthly basis to ensure proper function. This can be done with the supplied reagent drops and a pH color chart.
- ▶ When switching from one pH to another, it is good practice to let the water run for several seconds before using.
- ▶ It is common to drink half your body weight in ounces. For example, if you weigh 180 pounds, it may be wise to drink 90 ounces every day of water per day. This especially applies after you have given your body some time to adjust to the new pH level.
- ▶ The recommended drinking level for functional water is 9.5 pH (+-0.3). It is not recommended to drink functional water above a pH of 10.

- ▶ If you wish to store functional water, use a glass or other non-leaching material with an airtight lid and store it in the refrigerator. Functional water will begin to weaken immediately and will lose most of its benefits after 3 days.
 - ▶ Never run hot water through this unit.
 - ▶ Never drink acidic water.
-

Storage and Management Method After Usage

- ▶ Make sure the power is off when moving the unit.
- ▶ When cleaning, do not let water enter inside the main unit.
- ▶ Do not block output or bend, twist, or press hose.
- ▶ Use smooth cloth to lightly wipe the surface of main unit.
- ▶ Do not store in hot, humid places.

6.Component Parts

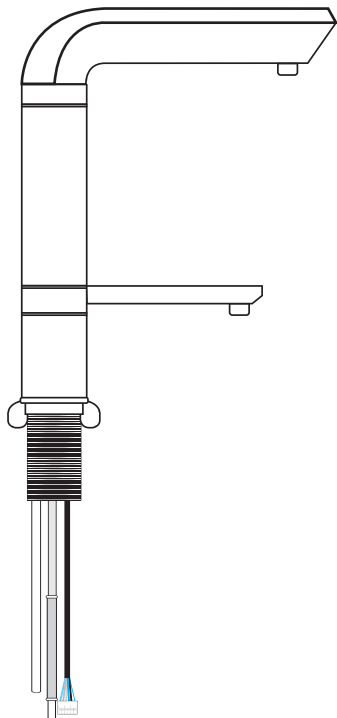

Main Body Faucet



Straight 1/4"

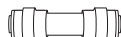

Straight 5/16"



Alkaline Water
Connection Nipple

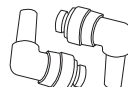

Stem Elbow 5/16"



Alkaline Water Line 5/16", 3M

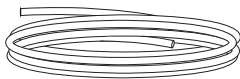

Tubing Hose 1/4", 1M

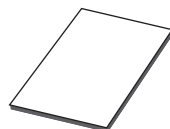

Manual

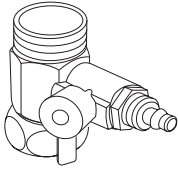

Adaptor (Small)



Dust Filter

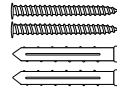

Installation Nails

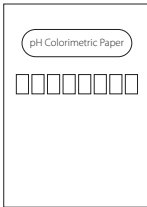

pH Colorimetric Paper

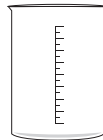

pH Measurement Cup
20CC



pH Reagent
10CC

7. Installation

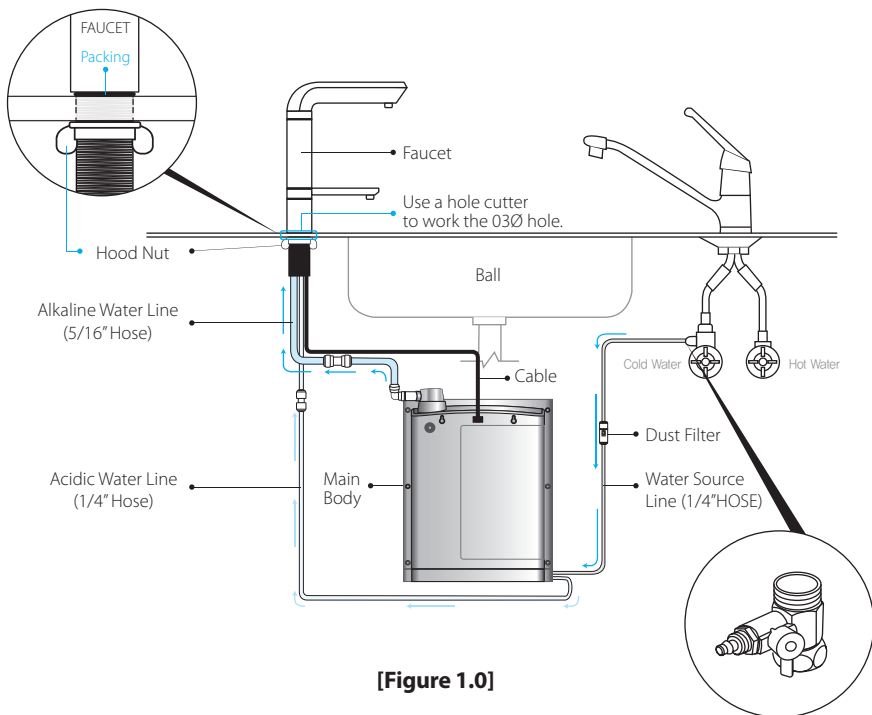

[Figure 1.0]

Preparing Installation

- 1 Shut off the main water supply (both hot and cold water) by closing the main valve under the sink.
- 2 Look for the cold-water supply line.
- 3 To separate the cold-water supply line from the main cold-water pipe, turn it counter-clockwise using a wrench. Dry the small amount of water that may come from the supply line using a towel.

Connecting the Adapter

- 4 Connect the tap water adapter to the main cold-water. Tighten with a wrench. Make sure the O-ring is inside the tap water adapter when connecting. This O-ring is crucial to preventing leakage.
- 5 Connect the cold-water supply line to the tap water adapter which is now secured to the main cold-water pipe. Tighten with a wrench.

※ Use Teflon tape (not included) at connections to prevent leakage.

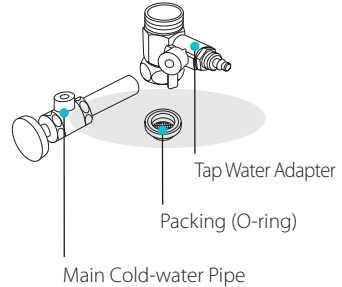

[Figure 1.1]

Connecting the Dust Filter

- 6 Remove the nut on the side of the tap water adapter. Connect the hose (1/4") to the adapter. Slide the nut through and tighten the nut back onto the adapter.
- 7 Cut the hose (1/4") in the middle. Attach the dust filter to one end of the hose by clicking it in place.

- ※ There is an arrow on the dust filter indicating water flow direction.
- ※ The dust filter will help filter out impurities from the supply water.
- ※ To remove the dust filter, press down onto the protruded part and pull.

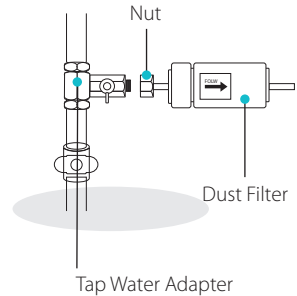

[Figure 1.2]

Completing Installation

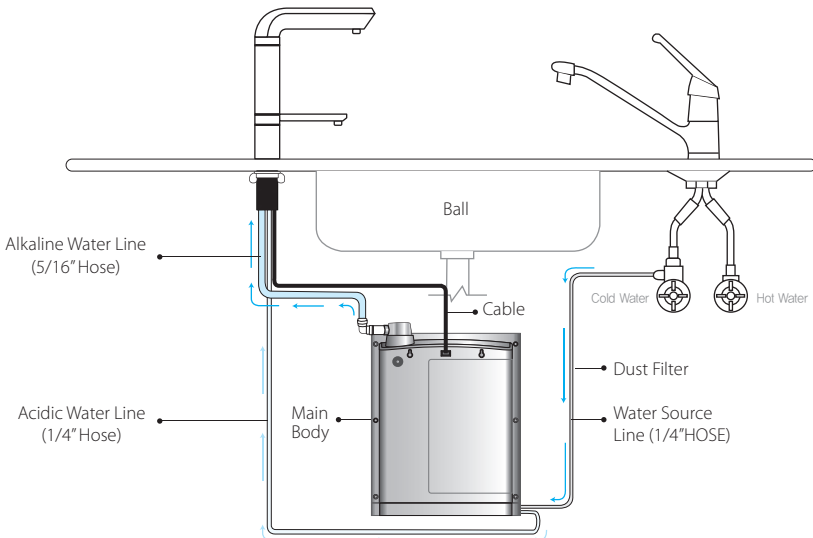

- 8** Attach the other end of the dust filter to the hose (1/4"). Connect the hose to the water supply inlet (1/4") on the machine.
- 9** Fix the faucet and the rubber ring onto the hole. Then, completely fix the faucet using the hood nut below the sink.
- 10** Use fitting to connect the alkaline, acidic hoses (attached to the faucet) to the main unit.
- 11** Connect the faucet connection cable to the main unit.
- 12** Make sure all connections are secure. Open the main valve and turn the power on.

After Installation

- 1 Make sure all the hose connections are sealed completely in the right holes both on the unit and at the water supply.

- 2 Turn on the hot/ cold water supply to make sure that there are no leaks at any of the connections or on the bottom of the unit, and that the faucet is working properly for the both water supply. Make sure the hoses are completely seated in the unit holes.

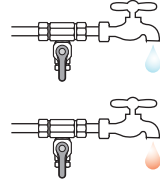

- 3 Plug in the power cord. There should be a series of tones when the unit is powered up.

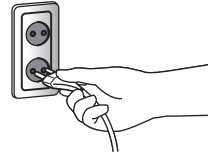

- 4 After the installation, drop 2 or 3 drops of pH reagent into a sample of water, mix and shake well, and compare to the pH scale color chart below:

Acidic Level 2 (Strongly Acidic)	Acidic Level 1 (Medium-Acidic)	CLEAN (Neutral)	Alkaline Level 1 (Mild Alkali)	Alkaline Level 2 (Medium Alkali)	Alkaline Level 3 (Strong Alkali)	Alkaline Level 4 (Strong Alkali)
For cleaning: - fruits - veggies - kitchen - towel - knives	For cleaning: - facial washing	For drinking: - take medication	For drinking	For drinking	For cooking: - cooking water - floriculture - tea brewing	For cleaning: - fruits - veggies - kitchen - towel - knives

If the pH result doesn't match with the color on the pH scale color chart, please refer to the user manual page 26, "LE Mode: Changing pH Level" to begin the pH setting mode and change to the desired pH level based on the pH scale color chart above.

8. Basic Functions

Classification	Detail	Page
Basic Functions	<ul style="list-style-type: none"> ▶ Selectable Stage: Alkaline water 4 (1, 2, 3, 4), Acidic water 2 (1, 2), Purified water (1) 	
	<ul style="list-style-type: none"> ▶ Volume Control Setting: Begin Volume Control Mode by touching ACD button for 5 seconds. <ul style="list-style-type: none"> - Navigate stages 1 ~ 9 by lightly touching ACD button. (repeats stages 1 ~ 9) - 5 seconds after volume change, the setting is automatically completed and saved. (Automatically changed to standby mode) 	
	<ul style="list-style-type: none"> ▶ Action Conditions <ul style="list-style-type: none"> - When on pause after using alkaline or acidic water, the system will automatically switch to water purification. - During operation, it is possible to switch to alkaline or acidic water. 	
	<ul style="list-style-type: none"> ▶ DARC LED Bar <ul style="list-style-type: none"> - Light On: DARC (flow channel) system in operation. - Blinking: An error in DARC. (flow channel) (01 ~ 07) - Light Off: DARC (flow channel) motor on pause in a normal state. 	
	<ul style="list-style-type: none"> ▶ FLOW LED Bar <ul style="list-style-type: none"> - Light On: Normal flow rate. (over 0.5L/ min) - Blinking: Insufficient flow rate. (under 0.5L/ min) - Light Off: On pause or water supply has been cut off during operation. 	
	<ul style="list-style-type: none"> ▶ Filter LED Bar <ul style="list-style-type: none"> - Blinking: No filter. - Light Off: Filter remaining. (In normal use) 	
	<ul style="list-style-type: none"> ▶ Filter Reset <ul style="list-style-type: none"> - When in operation or on pause, touch the ON/OFF button for 10 seconds to reset filter. When reset is complete, there will be a beep sound and a voice message. 	
	<ul style="list-style-type: none"> ▶ Forced Operation Function (Emergency Function): Forced operation to use when a water flow sensor is defective. <ul style="list-style-type: none"> - Touch ALK button for 5 seconds to use this function. 	
	<ul style="list-style-type: none"> ▶ “Lock” <ul style="list-style-type: none"> - Button Lock Function: Press “ALK+ON/OFF+ACD” buttons simultaneously for 3 seconds to lock. - Button Unlock Function: Press “ALK+ON/OFF+ACD” buttons simultaneously for 3 seconds to unlock. - Automatic Unlocking: after 5 minutes the buttons automatically unlock. 	

9. How to Release Alkaline Water

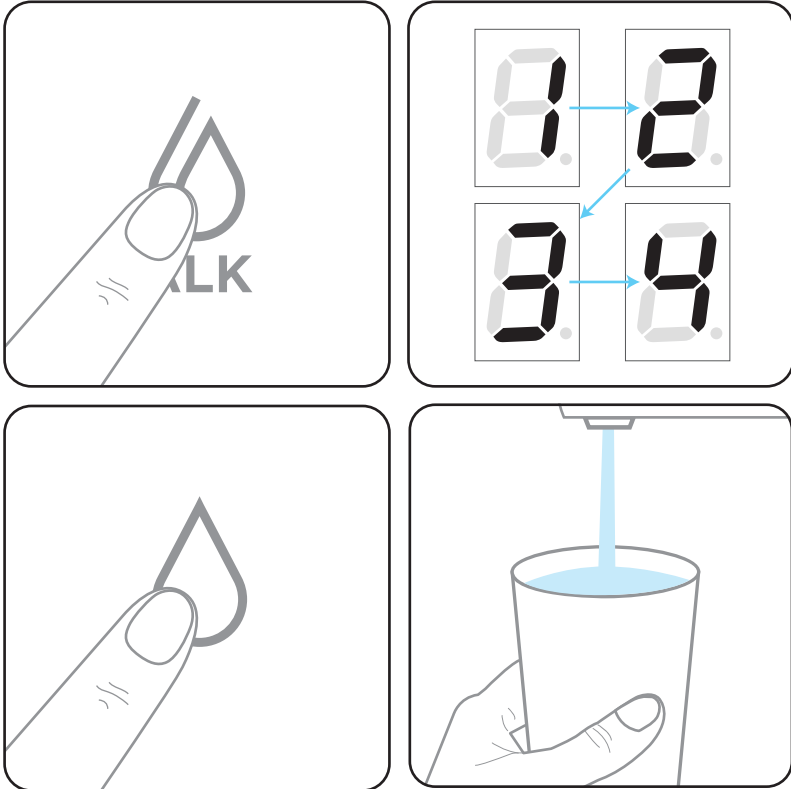

- 1 Touch the ALK button to select the desired alkaline water stage (stages 1 ~ 4).
- 2 After selecting the desired stage, touch the ON/OFF button to release alkaline water.
- 3 Once enough quantity of water has been released, touch the ON/OFF button again to stop releasing water.
- 4 Once stopped, the system will switch automatically to alkaline water function.

10. How to Release Purified Water

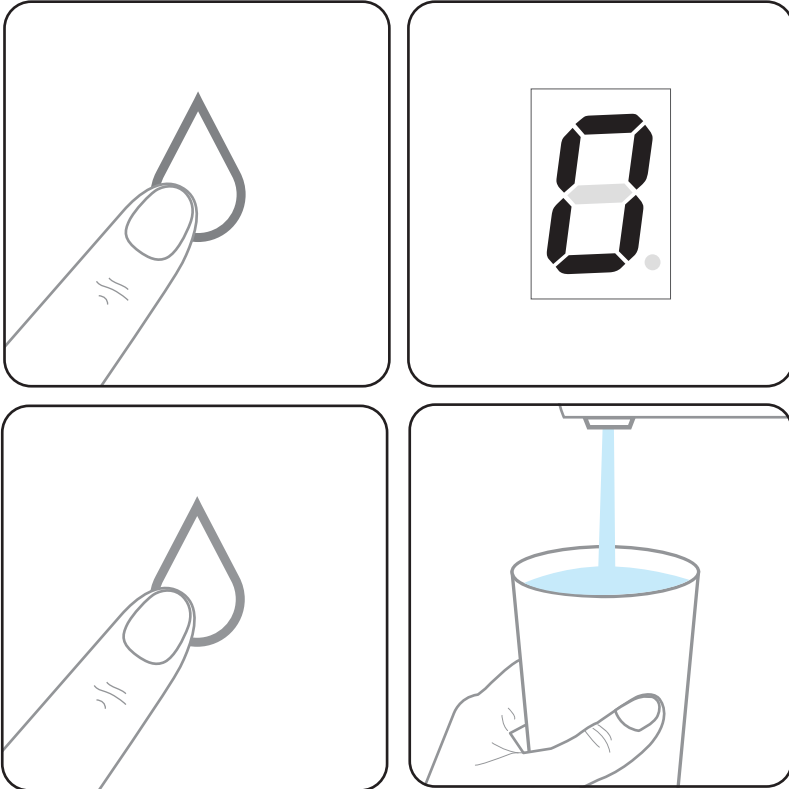

- 1 Touch the ON/OFF button to release purified water.
- 2 Once enough quantity of water has been released, touch the ON/OFF button again to stop releasing water.

1. How to Release Acidic Water

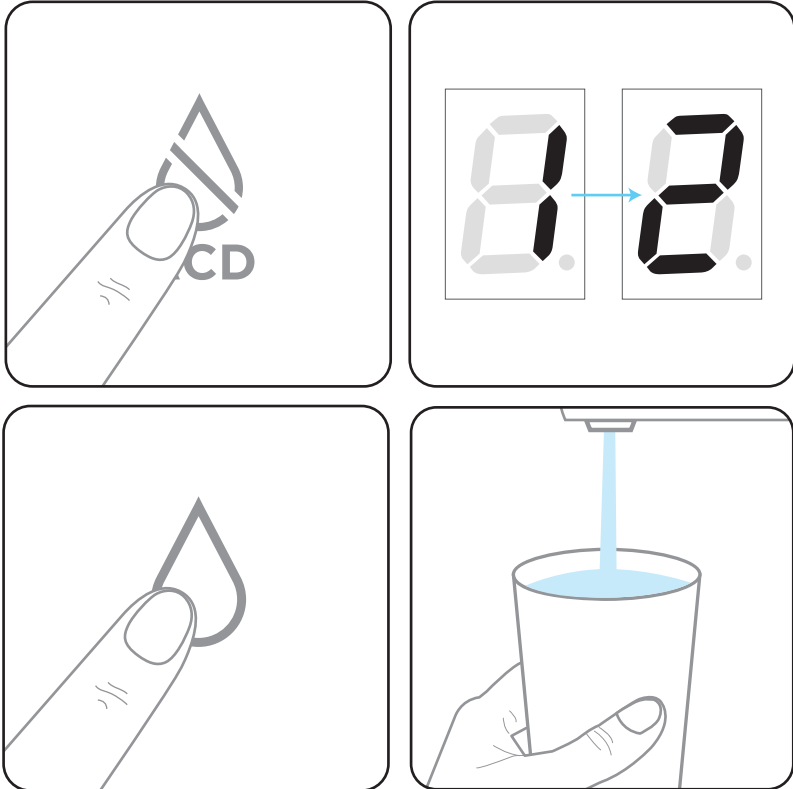

- 1 Touch the ACD button to select the desired acidic water stage (stages 1 ~ 2).
- 2 After selecting the desired stage, touch the ON/OFF button release acidic water.
- 3 Touch ON/OFF button again to stop releasing water.
- 4 Once stopped, the system will switch automatically to alkaline water function.

12. How to Set Button Lock

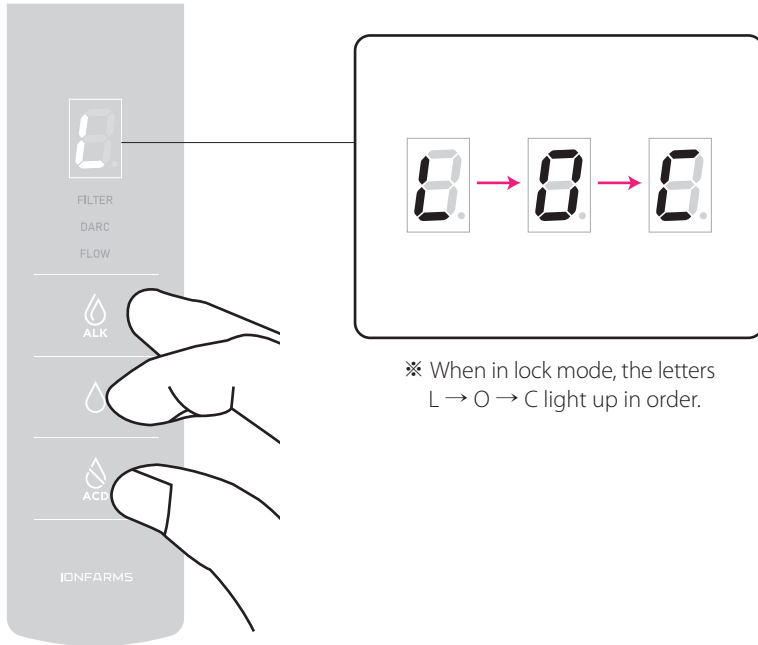

[Button Lock Mode Screen]

Button Lock Function

- ▶ Function to prevent the buttons from operating when cleaning the surface of the product
- ▶ **How to Enter Lock Mode**
Touch "ALK + ON/OFF + ACD" buttons simultaneously for 3 seconds to enter button lock mode with a beep sound.
- ▶ **How to End Lock Mode**
 - ① Touch "ALK + ON/OFF + ACD" buttons simultaneously for 3 seconds to end lock mode.
 - ② After 5 minutes of lock mode, the system will automatically unlock with a beep sound.

13. Water Flow Rate Per Minute

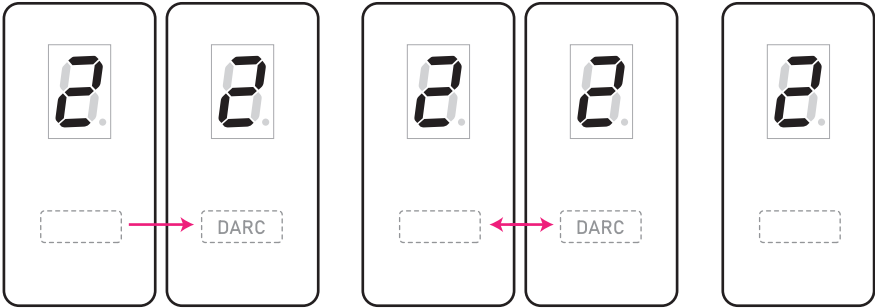

Flow Channel (DARC) LED

- 1 Light On: DARC system in operation
- 2 Blinking: an error in the flow channel
- 3 Light Off: DARC motor on pause (normal)

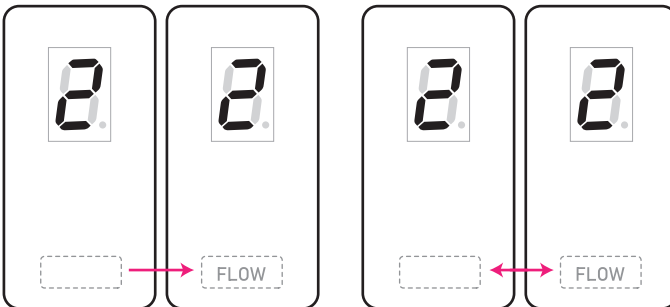

Flow Rate LED

- 1 Light On: normal flow rate (over 0.5L/min)
- 2 Light Off: error in flow rate (under 0.5L/min)

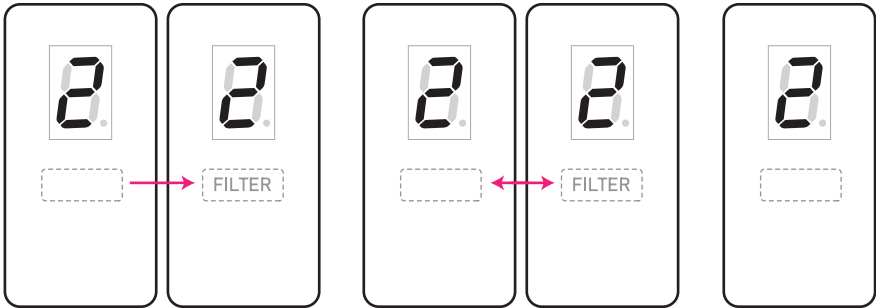

Filter LED

- 1** Light On: filter remaining to be used
- 2** Blinking: no filter left
- 3** Light Out – Paused: remaining filter amount does not matter

4. Setting Mode 01 Breakdown

Classification	Menu	Details																								
Setting Mode 01	Initial Screen When Beginning	 <ul style="list-style-type: none"> ▶ To Start Touch "ALK + ACD" simultaneously for 3 seconds while on pause ▶ To End Touch "ACD" button for 3 seconds to end setting mode ▶ Key to Change Mode - ACD Button ▶ Key to Change Value - Up Key → ALK Button - Down Key → ON/OFF Button 																								
	LE (Level 1 ~ 7)	<ul style="list-style-type: none"> ▶ Raw Water: Possible to Adjust the pH Value - Initial Setting: 04 - 01~07 Levels Available to Setting (7 Levels) 																								
	EC (Extra Cleaning)	<ul style="list-style-type: none"> ▶ Extra Cleaning Time Setting: 0 Sec. ~ 8 Sec. - Initial Setting: 04 <table border="1" style="width: 100%; border-collapse: collapse;"> <thead> <tr> <th>EC</th> <th>Details</th> <th>EC</th> <th>Details</th> </tr> </thead> <tbody> <tr> <td>0</td> <td>No extra-cleaning</td> <td></td> <td></td> </tr> <tr> <td>1</td> <td>1 sec cleaning</td> <td>5</td> <td>5 sec cleaning</td> </tr> <tr> <td>2</td> <td>2 sec cleaning</td> <td>6</td> <td>6 sec cleaning</td> </tr> <tr> <td>3</td> <td>3 sec cleaning</td> <td>7</td> <td>7 sec cleaning</td> </tr> <tr> <td>4</td> <td>4 sec cleaning</td> <td>8</td> <td>8 sec cleaning</td> </tr> </tbody> </table>	EC	Details	EC	Details	0	No extra-cleaning			1	1 sec cleaning	5	5 sec cleaning	2	2 sec cleaning	6	6 sec cleaning	3	3 sec cleaning	7	7 sec cleaning	4	4 sec cleaning	8	8 sec cleaning
	EC	Details	EC	Details																						
0	No extra-cleaning																									
1	1 sec cleaning	5	5 sec cleaning																							
2	2 sec cleaning	6	6 sec cleaning																							
3	3 sec cleaning	7	7 sec cleaning																							
4	4 sec cleaning	8	8 sec cleaning																							
LA (Language 1 ~ 7)	<ul style="list-style-type: none"> ▶ Language Selection: - Initial Setting: 02 <table border="1" style="width: 100%; border-collapse: collapse;"> <thead> <tr> <th>LA</th> <th>Details</th> <th>LA</th> <th>Details</th> </tr> </thead> <tbody> <tr> <td>1</td> <td>Korean</td> <td>5</td> <td>Spanish</td> </tr> <tr> <td>2</td> <td>English</td> <td>6</td> <td>Russian</td> </tr> <tr> <td>3</td> <td>Chinese</td> <td>7</td> <td>-</td> </tr> <tr> <td>4</td> <td>German</td> <td>8</td> <td>-</td> </tr> </tbody> </table>	LA	Details	LA	Details	1	Korean	5	Spanish	2	English	6	Russian	3	Chinese	7	-	4	German	8	-					
LA	Details	LA	Details																							
1	Korean	5	Spanish																							
2	English	6	Russian																							
3	Chinese	7	-																							
4	German	8	-																							

How to Operate Setting Mode 01

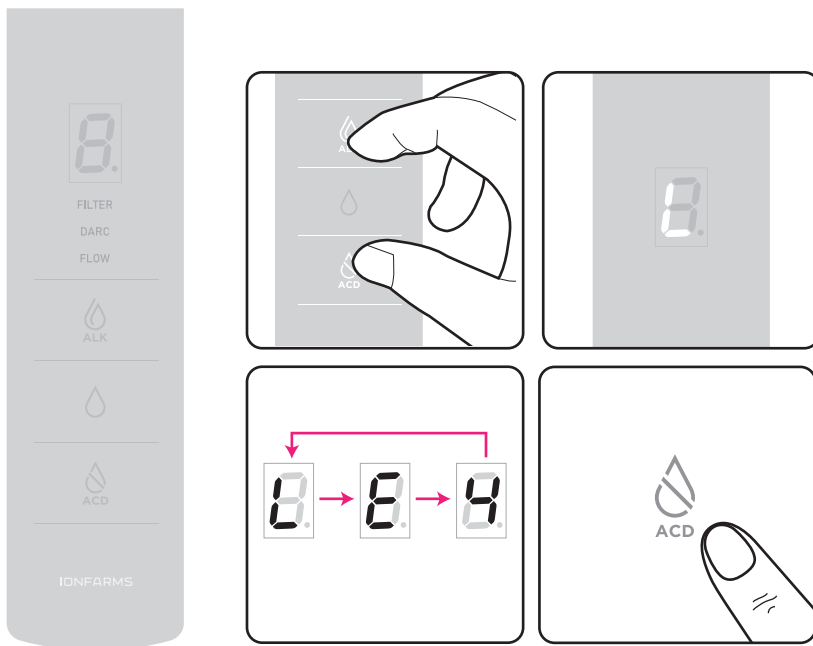

[Standby Mode]
[Setting Mode Ended]

How to Begin Setting Mode

- ▶ When on pause, touch "ALK+ACD" buttons simultaneously for 3 seconds to enter setting mode.

How to End Setting Mode

- ▶ While in setting mode, touch the ACD button for 3 seconds to end setting mode.

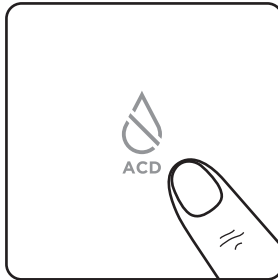

[Key to change a Mode]

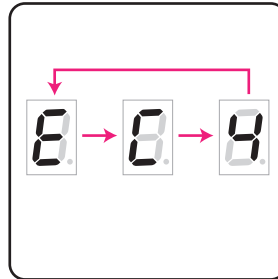
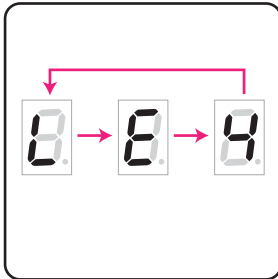
[ALK Button: Key to Increase Value]
[ON/ OFF Button: Key to Decrease Value]

Mode Change: ACD Button (LE → EC → LA)

- ▶ LE Mode: L→E→4 lighted repeatedly
 - ※ The number on display here is the set value.
- ▶ EC Mode: E→C→4 lighted repeatedly
 - ※ The number on display here is the set value.

Changing Mode

- ▶ Key to Change Mode: ACD Button

Changing Value

- ▶ Up Key: ALK Button
- ▶ Down Key: ON/ OFF Button

>> LE Mode: Changing pH Level (1 ~ 7)

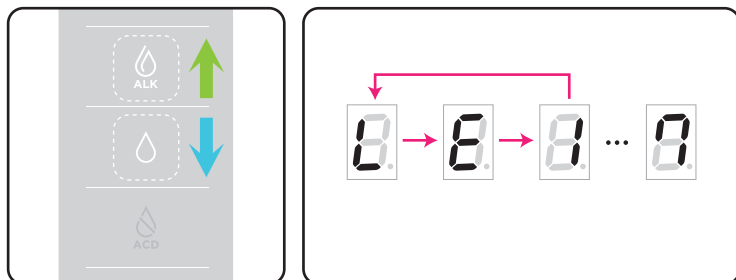

- ▶ Up Key: ALK Button - Key to Increase Value
- ▶ Down Key: ON/OFF Button - Key to Decrease Value
- ▶ When setting the pH level, every pH level will be adjusted with the same rate. (Initial Setting: Level 4)

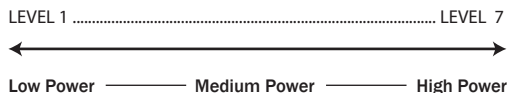

>> EC Mode: Extra Cleaning Time Setting (0 ~ 8)

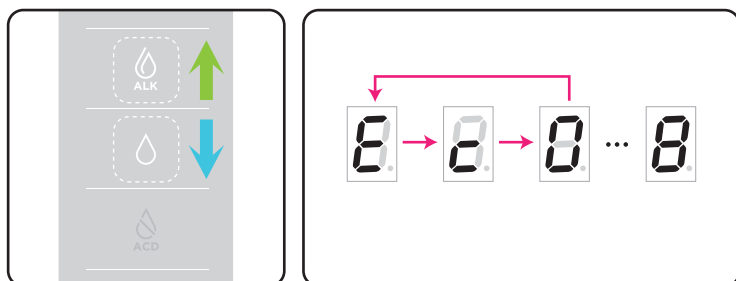

- ▶ Lighted up repeatedly, time setting range is 0 sec ~ 8 sec.
- ▶ Up Key: ALK Button - Key to Increase Value
- ▶ Down Key: ON/OFF Button - Key to Decrease Value

- ▶ When cleaning function is set, the solenoid valve is ON and the electrolyzer reverses polarity for the amount of time set.
- ▶ When cleaning function is set, the solenoid valve and the electrolyzer shut off automatically after the set amount of time.

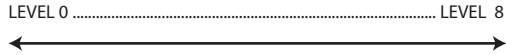

▶ **What is extra-cleaning?**

To remove remaining alkaline minerals inside the product by releasing acidic water 30 seconds after releasing water. For example, "4 sec cleaning" means acidic water being released for 4 seconds.

※ Extra-cleaning starts 30 seconds after a water release. Please turn the water outlet tube towards the sink for extra-cleaning drainage.

>> **LA Mode: Language Selection (1 ~ 8)**

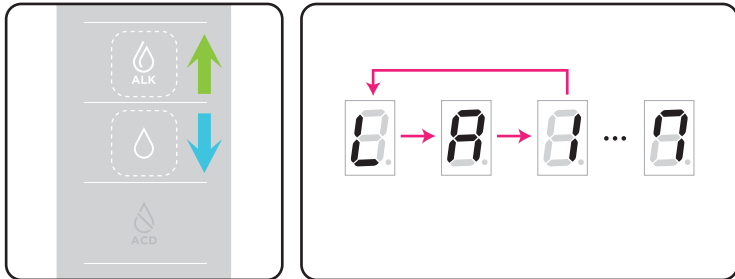

- ▶ Up Key: ALK Button - Key to Increase Value
- ▶ Down Key: ON/OFF Button - Key to Decrease Value

LA	Language Selected	LA	Language Selected
1	Korean	5	Spanish
2	English	6	Russian
3	Chinese	7	-
4	German	8	-

15. Setting Mode 02 Breakdown (Checking Mode)

Classification	Menu	Details
Setting Mode 02	Initial Screen When Beginning	<ul style="list-style-type: none"> ▶ To Start Touch "ALK+ON/OFF" buttons simultaneously for 3 seconds while on pause to begin. ▶ To End Touch "ACD" button for 3 seconds while in operation. ▶ To Change Mode : Use "ACD" button. F → P → A → C → T → Pn → Fn circulation in this order ▶ Display Method "chosen mode → tens thousands → ones thousands → hundreds → tens → ones → first decimal digit" displayed in order repeatedly. ※ The display will first show the chosen mode, then the digits of the corresponding number.
	F0	▶ Amount of Filter Used : F 1 2 3 4 5 6 (= 1 2 3 4 5 . 6 ℓ)
	P0	▶ Amount of Purified Water Used: P 1 2 3 4 5 6 (= 1 2 3 4 5 . 6 ℓ)
	A0	▶ Amount of Alkaline Water Used: A 1 2 3 4 5 6 (= 1 2 3 4 5 . 6 ℓ)
	C0	▶ Amount of Acidic Water Used: c 1 2 3 4 5 6 (= 1 2 3 4 5 . 6 ℓ)
	T0	▶ Display Total Amount of Water Used: t 1 2 3 4 5 6 (= 1 2 3 4 5 . 6 ℓ)
	Pn	▶ MAIN PCB VERSION: P n 1 2 3 4 (M A I N V E R S I O N = 1 2 3 4)
	Fn	▶ FRONT PCB VERSION: Fn1234 (FRONT VERSION = 1234)

How to Operate Setting Mode 02

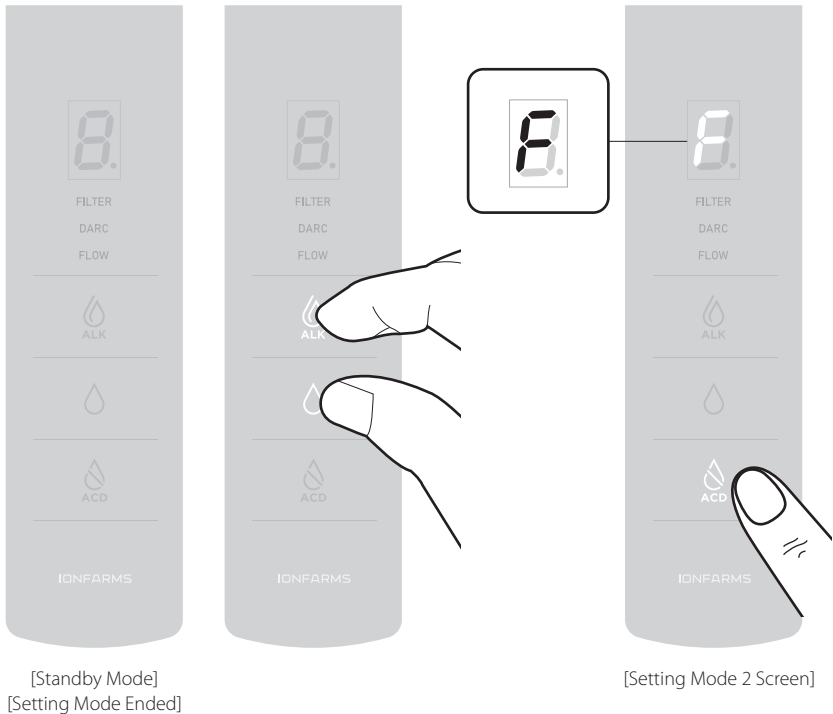

How to Begin Setting Mode 02

- ▶ While on pause, touch "ALK + ON/OFF" buttons simultaneously for 3 seconds to begin setting mode 2.
 - ※ Displays the selected mode.
 - ※ Initially set as "F"

How to End Setting Mode 02

- ▶ While in setting mode 2, touch ACD button for 3 seconds to end the setting mode.
- ▶ How to Change Mode
 - ACD Button

>> FO: Display Amount of Filter Used

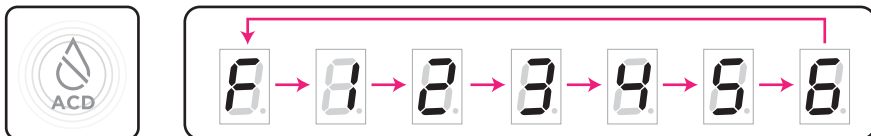

- ▶ Lighted repeatedly, the number indicates the amount of filter used
- ▶ 0 ~ 5,000L Count Range
- ▶ Displays up to 5 digits (0000.0) EX: 1234.5 = 1234.5L Used (the filter currently in use)

[F: Displays Amount of Filter Used]

※ EX: 12345.6ℓ

※ Display Method:

"F → tens thousands → ones thousands → hundreds → tens → ones → first decimal digit" displayed in order repeatedly.

>> PO Mode: Display Amount of Purified Water Used

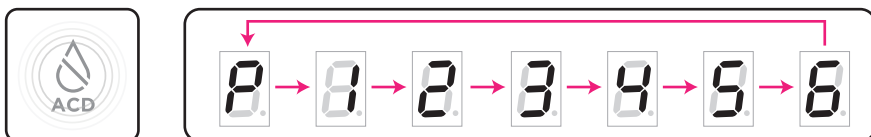

- ▶ Lighted repeatedly, the number indicates the amount of filter used
- ▶ 0 ~ 5,000L Count Range
- ▶ Displays up to 5 digits (0000.0) EX: 1234.5 = 1234.5L Used (the filter currently in use)

[P: Displays Amount of Filter Used]

※ EX: 12345.6ℓ

※ Display Method:

"P → tens thousands → ones thousands → hundreds → tens → ones → first decimal digit" displayed in order repeatedly.

>> AO: Display Amount of Alkaline Water Used

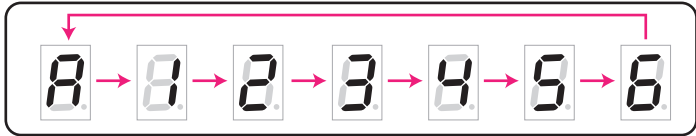

- ▶ Lighted repeatedly, the number indicates the amount of filter used
- ▶ 0 ~ 5,000L Count Range
- ▶ Displays up to 5 digits (0000.0) EX: 1234.5 = 1234.5L Used (the filter currently in use)

[A: Displays Amount of Alkaline Water Used]

※ EX: 12345.6ℓ

※ Display Method:

"A → tens thousands → ones thousands → hundreds → tens → ones → first decimal digit" displayed in order repeatedly.

>> CO: Display Amount of Acidic Water Used

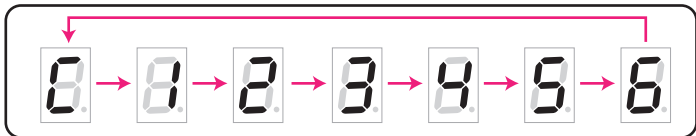

- ▶ Lighted repeatedly, the number indicates the amount of filter used
- ▶ 0 ~ 5,000L Count Range
- ▶ Displays up to 5 digits (0000.0) EX: 1234.5 = 1234.5L Used (the filter currently in use)

[C: Displays Amount of Acidic Water Used]

※ EX: 12345.6ℓ

※ Display Method:

"C → tens thousands → ones thousands → hundreds → tens → ones → first decimal digit" displayed in order repeatedly.

>> **TO: Display Total Amount of Water Used (the actual meaning of total amount: the cumulative amount since initial purchase)**

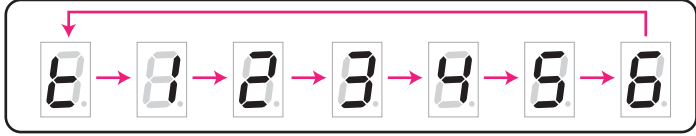

- ▶ Lighted repeatedly, the number indicates the amount of filter used
- ▶ 0 ~ 5,000L Count Range
- ▶ Displays up to 5 digits (0000.0) EX: 12345.6=12,345.6L Used (the product becomes the standard, the value is reset when it is released)

[t: Displays Total Amount of Water Used]

※ EX: 12345.6ℓ

※ Display Method:

"t → tens thousands → ones thousands → hundreds → tens → ones → first decimal digit" displayed in order repeatedly.

>> **PN: MAIN PCB PGM Version No. – changes whenever PGM changes**

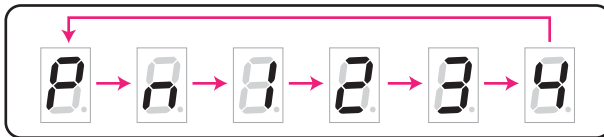

- ▶ Lighted repeatedly, the number indicates version

[PN: Confirmation Mode Display Screen]

※ EX: MAIN PCB PGM Version = LL03

>> **FN: FRONT PCB PGM Version No. – changes whenever PGM changes**

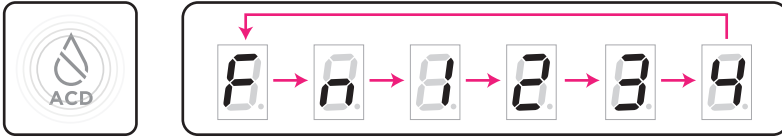

▶ Lighted repeatedly, the number indicates version

[Fn: Confirmation Mode Display Screen]

※ EX: FRONT PCB PGM Version = 1B03

16. Measuring pH/ Replacing Fuse

pH measurement method

Drop 3 drops of pH reagent liquid in container and fill it with 10cc of water to be measured. Shake 2 ~ 3 times and the color will change. Compare the color with colorimetric paper and read the color's value to complete measurement.

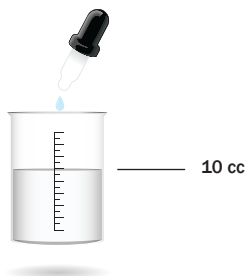

pH concentration color table

Do not put pH measured water into eye or drink it. Seal pH measured water and store in place away from children's hands. Do not place near fire. It may cause fire.

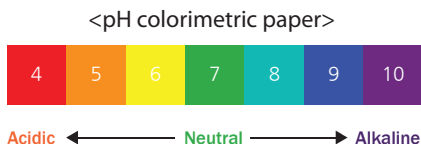

Fuse change

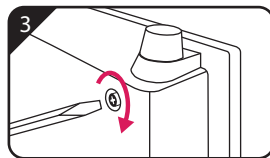
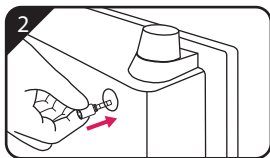
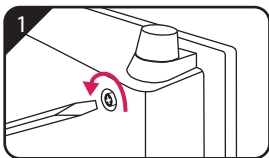

The fuse is located at the upper portion of the back of the unit.

- 1) The fuse can be removed if rotated counter-clockwise with a screwdriver.
- 2) Insert the new fuse (3.15A).
- 3) Tighten the fuse by rotating it clockwise with a screwdriver.

Note: When changing the fuse, please make sure to unplug the power cord first. Not doing so may cause electric shock.

17. Filter Configuration

Multi-functional filter (lifespan: 6 months)

- ▶ Sediment filter
- ▶ Powdered activated carbon
- ▶ Granular activated carbon
- ▶ High density FELT film
- ▶ Granular activated carbon
- ▶ Ceramic (Quartz)
- ▶ Ceramic (Zio_2, Sio_2)
- ▶ Calcium Sulfite
- ▶ Ceramic (Zeolite, silver)

※ Filter materials may differ depending on regions.

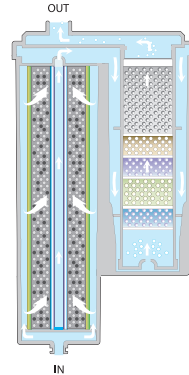

- ※ To drink clean water, exchange filter regularly according to filter exchange period.
- ※ Exchange filter when the filter exchange icon on display unit flashes.
- ※ Even if filter exchange icon does not operate, exchange if any of the following cases occur.
 - When there is smell or odd taste
- ※ Filter exchange period may differ depending on usage amount, water quality, and water pressure.
- ※ For more details, please refer to the details on the sticker attached to the filter. (refer to display matters)

Usage environment and condition

- ▶ Do not use source water unsuitable by Waterworks Law standard.
- ▶ Do not use in place with high temperature such as bathroom.
- ▶ Do not use in place with high humidity or temperature.
- ▶ Do not use in chemical drug storage or area generating gas.
- ▶ Do not use in place affected by air pressure, wind, sunlight, salt, etc.
- ▶ Please use in stable location without slope.
- ▶ Do not use in place with low water pressure (below 14.2psi) and source water quantity (under 1ℓ/min).
- ▶ Usage condition
 - ※ Temperature: $\pm 5^{\circ}C \sim +50^{\circ}C$
 - ※ Moisture: $\pm 70\%$
 - ※ Air pressure: 1013hpa \sim 877hpa

18. Replacing Filter

Please use the genuine filters only. The seller and the manufacturer are not responsible when inauthentic filters are used. (How to check authenticity: Check if the hologram sticker inside the filter cover and the sticker on the filter replacement box are the same.)

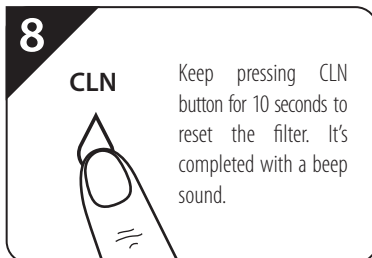
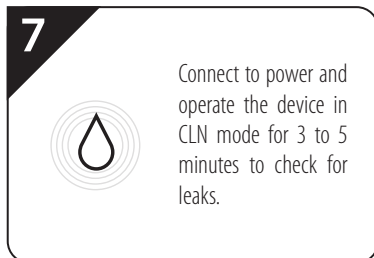
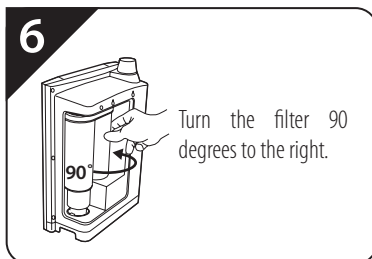
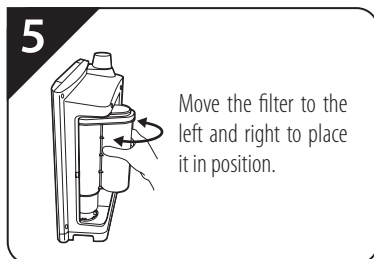
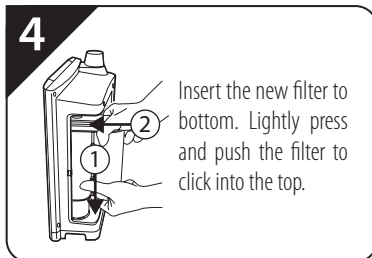
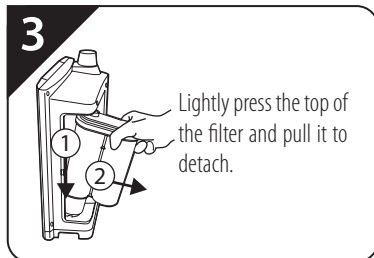
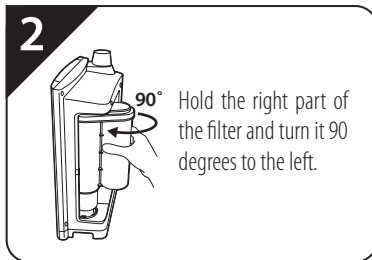
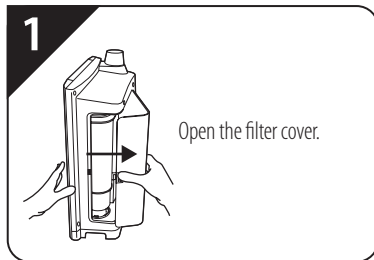

19. How to Reset Filter

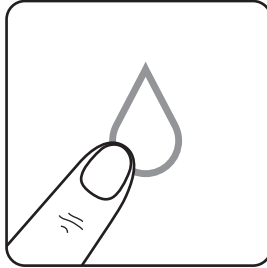

- 1** While in operation or in pause, touch the ON/OFF button for 10 seconds continuously to reset filter.
- 2** Once reset is complete, there will be a beep sound and a voice notice.

20. Troubleshooting

If there is ANY TROUBLE IN OPERATING this device, please read the instructions carefully and use the checklist below. Please call your local representative if there is still a problem.

Symptoms	Things to check for	Possible solutions
No power to the unit or the ON/ OFF button does not illuminate.	Are the power cord and plug properly connected?	Plug in properly and switch on the power to the unit.
	When you are satisfied that the unit is receiving power but the ON/ OFF button does not illuminate, check the internal fuse.	If the fuse has blown, then replace the fuse. Please see "how to change the fuse."
There is power to the unit, the ON/ OFF button illuminates but there is sporadic or no water generation.	Is the water supply cutoff valve open?	Open the water supply cutoff valve.
	Check ALL water supply connections.	Connect all pipes properly
	Water supply hose bent or folded?	Ensure that the water hose is free from constrictions.
	Low water pressure? (Below 0.7 kg/ cm ²)	The unit cannot be used in areas of low water pressure. Contact your local representative.
	No feed water supply or frozen?	Wait until water supply resumes
	Filter blocked?	Replace filter.
NO alkalinity?	Check if any figure appears on the screen.	See how to adjust machine according to feed water quality.
Low alkalinity?	Do you reside in an area of high water hardness?	Alkalinity will be different depending on water hardness area and feed water quality.
	Over supply of water?	Reduce the amount of feed water supply flow. (Normal: 2~3bar of 5)
	Not enough drainage?	Contact your local representative.
Stops in the middle of operation.	Has continuous operation time passed 10 minutes?	The unit automatically stops after 10 minutes of continuous operation. Please wait for the on button on the screen to illuminate. The unit will then be ready to use.
Leakage from filter	Is it installed properly?	Replace the filter. If the problem persists then contact your local distributor. Some leakage possibly in filter. Stop operation and ask for help from Local Rep.
	Any leakage in the main body?	
There are strang odor or the water tastes different.	Unused for a long time?	Flush water for more than 3~5 minutes. If the problem persists, replace the filter.
	Excess alkalinity?	Increase the water supply by opening the supply valve.
	Filter change overdue?	Replace filter.
Water does not look clean.	Is something white deposited at the base of the container?	Calcium or other minerals can be present depending on area. No problem to drink water.

21. Specifications

Manufacturer	IonFarms Co.,Ltd
Product Name	Alkaline Water Ionizer
Model	Alpha-U1500/ U1700
Rated Voltage	AC100~120V; 50~60Hz/ AC220~240V; 50~60Hz
Electric Consumption	Max. 160W
Power Protector	Fuse 3.15A
Weight	
Packaging Unit	1 EA
Required Water Pressure	98 kPa ~ 686 kPa
Instructions	Refer to User Manual
Water Volume Generated	2 ~3 liters/ min (0.53 gallon ~ 0.79 gallon/min)
Cleaning	Automatic Cleaning System
Filter Lifespan	5000 liters/ 6 months (may vary by water quality - Hardness)

- ※ The above specifications are subject to change without notice for performance improvement.
- ※ Home use only.

22. Product Warranty

Product Warranty

★ Alkaline Water Ionizer ★

Product Name: Alkaline Water Ionizer

Manufacturer's Serial Number: _____

Model Name: _____

Purchase Date: _____

Seller: (Name) (Phone Number) (Address)

Buyer: (Name) (Phone Number) (Address)

This alkaline water ionizer is manufactured under strict quality control and inspections. When the product is defective while being used correctly, the repair will be done for free of charge based on this product warranty. This product is warranted for 3 years (36months).

- When requesting a repair, please submit the warranty to the purchased store or to the after-sales service center.
- In the case the warranty is not submitted, please talk to one of the staff members at the purchased store.
- This warranty won't be reissued, so please keep this well.
- After the warranty period expires, repairs costs will be charged against failures.

Warranty regulations.

1. When the product is defective while being used correctly, repair will be done for free of charge within the warranty period.
2. The warranty period is three years after purchase, and accessories are excluded.
3. Repair fee will be charged even within the warranty period for the following cases:
 - 1) Malfunctions or defects by customers' misuse, arbitrary disassemble, configuration or fix.
 - 2) Malfunctions or defects by changing the initial installation place, or falling
 - 3) Malfunctions or defects by natural disasters such as fire, salt damage, gas damage, abnormal voltage, earthquake, thunderstroke, and wind and flood damage.
 - 4) Omission of the purchased year, month, day or store on the warranty or arbitrary amendment of this warranty.
 - 5) No submission of the warranty.
 - 6) Repairs or modifications done by non-authorized representatives.
 - 7) Usage other than domestic use.



Memo

A series of horizontal dashed lines for writing a memo.

<http://www.ionfarms.com>

